

# **Vibrating Caregiver Pager User Manual**

# Brief introduction

The wireless caregiver pager is specially designed for patients, the disabled, elderly, pregnant women or children. Simply press call button to alert the caregiver via the vibrating receivers.

Main Features:

1. 100 meters working range in open air;
2. Built in 50+ selectable melodies, volume adjustable;
3. Vibration and loud music for reminding, additional mute function to avoid disturbing others;
4. IP55 Waterproof panic button with mini size and neck strap, easy to carry;
5. Learning code and expandable, up to 50 transmitter or receivers can be easily added by users;
6. Easy installation and operation;
7. Low power consumption.

# Specifications

Parameter	Vibrating receiver	Transmitter
Voltage	3V DC power (AAA batteries*2)	CR2016 battery * 2
Operating temperature	-15 °C~55°C	-20 °C~55°C
Transmission distance	100m in open air	
Operating frequency	433.92MHz ±200KHz	
Volume	0~110dB	
Power consumption	0.1 W	

# Structure diagram of products

## Panic button (Transmitter)

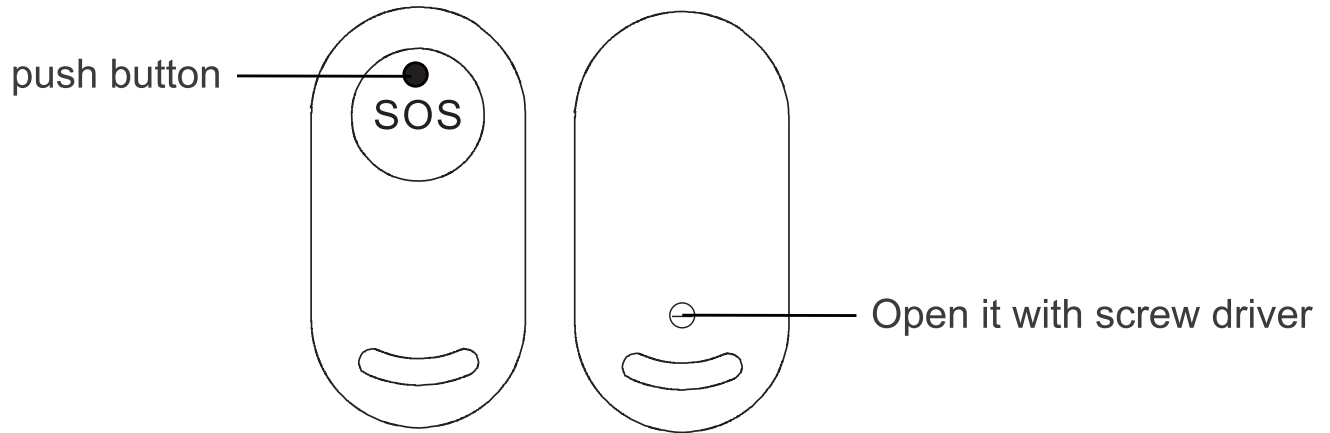

## Vibrating receiver (Portable)

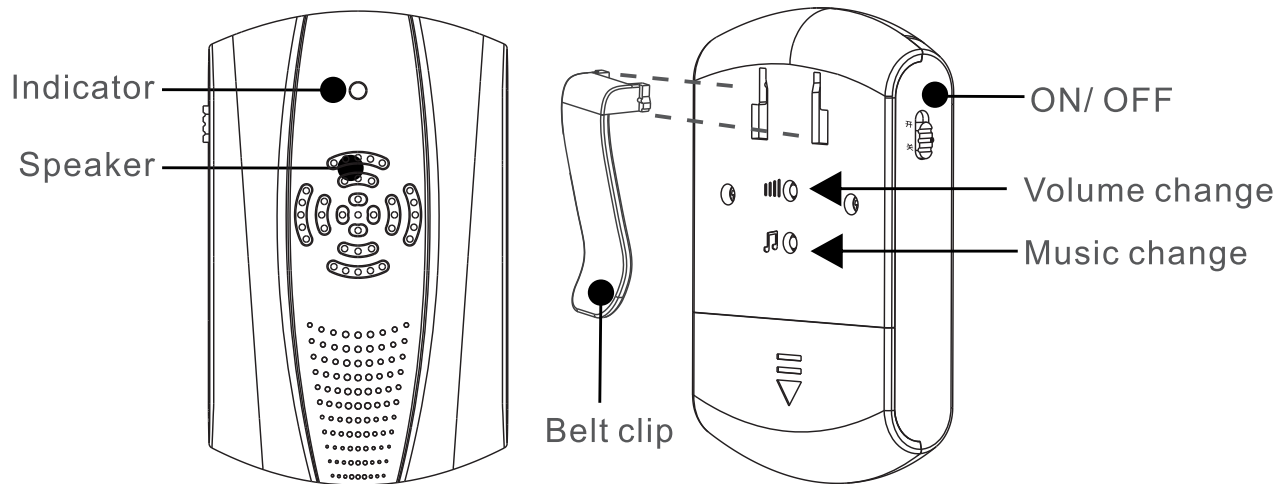

## Notice before installation

Caregiver Pager With Call Buttons relies on wireless radio technology which is subject to physical and environmental considerations. These products do not have an out of range function and as such should be tested periodically in the setting in which they are to be used to understand their area of effective operation.

1. Radio signal will be affected by metal, wall, concrete and barrier etc., the test distance in open air is 50-100 meter, generally, real operating distance through security doors, walls can be about 30-50 meter, which depends on the specific environment.
2. Please first test whether the operation range you choose is proper before install them.
3. Please don't place the transmitter close to other metal devices, if the operating range is short, please change the location of transmitter.
4. Please install the receivers away from induction cooker, television and horn where there is interference of magnetic and signal.
5. The shorter straight-line distance between receiver and transmitter is, the better performance of signal through wall is.
6. The product can be used directly without any settings if you do not add more receivers or transmitters and not change the default ring tone (Ding Dong).

## Installation Methods

### **For Receiver:**

Put 2 AAA batteries into vibrating receiver, and then it will vibrate and sound "Ding Dong" after getting signal from transmitter.

Please note that learning code doorbell needs re-matching if you want to add more transmitters or re-choose the ring tone.

### **For Transmitter:**

NOTE: Please first test whether the operating range you choose is working.

Panic button is easy carry, it can be hung around the neck as pendant or put in pocket, neck strap is included

## Warning

1. You'd better use the high quality battery, avoid using the ones with short life and easy leakage of electrolyte.
2. Be sure to protect the precision electronic components, non-professionals are not allowed to open it for maintenance.
3. Avoid installing the product to exposure place under sun and long rains directly.
4. Correct use of the products helps to effectively extend the lifetime.
5. The device is not a substitute for visual monitoring by a caregiver, it is not suitable for all individuals, other devices may be required. The manufacturer does not claim that this device will stop elopment and/or stop falls, it is designed to augment caregiver's management program. Test this device before each use.

## Operating Instruction

1. **Sound volume control:** press the volume change button on the receiver. This switch toggles between High and Low volume.

2. **Set Ringtone:**

Please follow the pairing steps (1)-(3) below to set a new ringtone.

3. **Pairing a transmitter to the receiver/Set a new ringtone**

(1) Press the **Music Change** button to select your favourite ringtone before pairing.

(2) Hold and press the **Volume Change** button for 5s until a "Ding-dong" is heard and the LED indicator starts flashing, you are now in pairing mode.

(3) Active the transmitter to send a signal to the receiver.

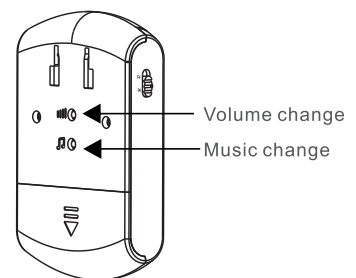

**Remarks:**

- (1) Pairing mode will quit automatically after pairing is completed.
- (2) Pairing mode will last for 5 seconds only.

**4. Two or more transmitters pairing:**

The pairing mode is available for a transmitter only each time. For two or more transmitters, please follow the pairing steps (1)-(3) once again to get transmitters paired one by one.

**5. Reset:**

Press **Music Change** button for 5 seconds to reset receivers to default. When receiver sounds 'Ding Dong' with LED flashing that means reset succeed, setting is back to default: It comes back to the 1st music, no transmitter is paired with receiver.

## Trouble Shooting

**1. The receiver doesn't sound**

- Check the doorbell button battery, replace it if necessary.
- The receiver could be out of range of the SOS panic button.
- The receiver may not have paired with the SOS panic button.
- Check that the volume control is not at the minimum settings.

**2. Operating range is reduced**

- Metal structures, including UPVC door frames can reduce the range of the product  
Avoid mounting the transmitter or receiver on or near metal structures.
- Other equipment can cause radio interference that affects your doorbell.
- Walls and ceilings will reduce the range.
- Weak batteries will reduce range. Replace every 12 -18 months.